

Absolute Rotary Encoders

Family C__22

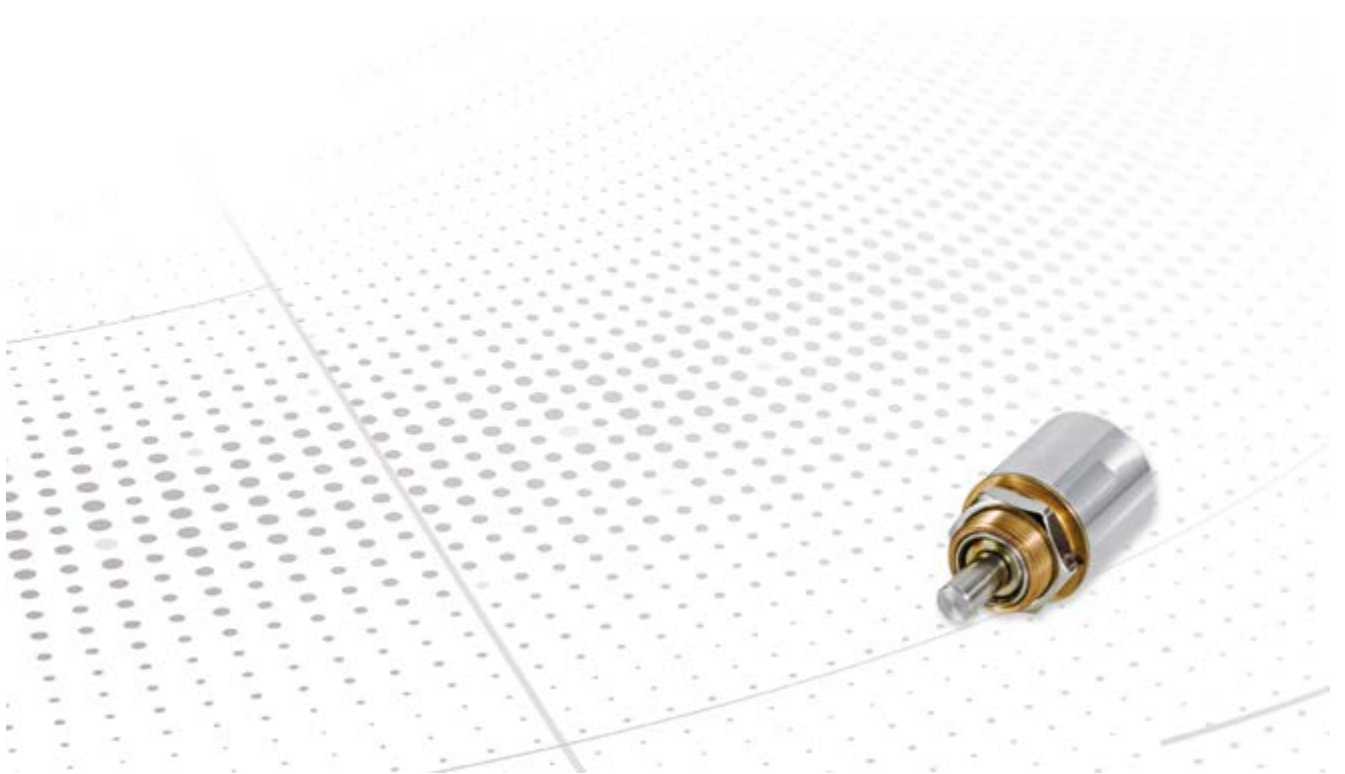

Encoder - Family C__22 - Housing 22 mm



Tiny but an absolutely real encoder!

Within the CMV 22 M we have combined our innovative ideas of rotary encoder technology and the experience gained over the years and placed it into a miniature rotary encoder. With a 22 mm diameter, it is the smallest absolute multi-turn rotary encoder of its kind. Amazingly compact, it can be easily mounted in the most confined machine spaces. The contact-free detection guarantees shock and vibration resistance which combined with its low mass make it perfect for use in demanding environments.





Application:

Direct installation into servo drives for wear-free, absolute position detection over several revolutions. The small size of 22 mm enables real multi-turn position measuring without battery back-up in fields such as apparatus construction and medical engineering, where up till now only incremental rotary encoders or multiple-ganged potentiometers were used.

Contents

Products.....	3
Suggested Products.....	4
Dimensional Drawings.....	5
Shaft Types.....	6

Magnet detection (M)

Product	CMV22M	CMV22M
		
Detection	Magnet detection (M)	Magnet detection (M)
Single / multi	(M) Multi	(M) Multi
Supply	7...26 VDC	14...30 VDC
Steps per turn	4096	4096
Number of turns	265	4096
Precision	± 1,0 °	± 1,0 °
Shaft diameters available	3mm, 6mm, 1/4"	3mm, 6mm, 1/4"
Connectors	Cable outlet radial	Cable outlet radial
Ambient temperature	0...+60 °C	0...+60 °C
Protection class	IP64	IP64
Interface	SSI ASI	Analog
Weblink	www.tr-electronic.com/s/S007235	www.tr-electronic.com/s/S007234
QR-Code		

Suggested Products

Order code	Steps per turn	Turns	Shaft / Flange	Connector position	Cable length	Remark
------------	----------------	-------	----------------	--------------------	--------------	--------

CMV22 - Analogue						
CMV22M-00007	1024	4	6GL/12,7 3/8"-32UNEF	Open end	0,200 m	Analogue voltage
CMV22M-00008	4096	256	1/4"X12 M16X1	Open end	0,500 m	Analogue voltage
CMV22M-00013	4096	10	6,35GL/12 with groove M16X1	1X8P.M12-connector	0,360 m	Analogue voltage
CMV22M-00022	1024	50	6GL/12,7 3/8"-32UNEF	Open end	5,000 m	Analogue voltage
CMV22M-00039	4096	4096	6GL/12,7 M16X1	Open end	1,000 m	Analogue voltage
CMV22S-00001	4096	1	1/4"X12 M16X1	Open end	0,500 m	Analogue voltage
CMV22M-00025	4096	256	1/4"X12 M16X1	Open end	0,500 m	Analogue current
CMV22S-00004	4096	1	1/4"X12 M16X1	Open end	0,500 m	Analogue current

CMV22 - SSI						
CMV22M-00005	4096	256	1/4"X12 M16X1	Open end	0,500 m	
CMV22M-00010	4096	256	1/4"X12 M16X1	Open end	0,500 m	
CMV22M-00017	4096	256	1/4"X12 M16X1	1X8P.M12-connector	0,300 m	
CMV22M-00037	4096	256	6GL/12,7 M16X1	Open end	10,000 m	
CMV22M-00041	4096	256	1/4"X12 M16X1	MOLEX-WIRE 6P	2,500 m	
CMV22S-00003	4096	1	1/4"X12 M16X1	Open end	0,300 m	

For further product information simply enter the order number in the search field at www.tr-electronic.de.

Dimensional Drawings

CMV22 Analogue

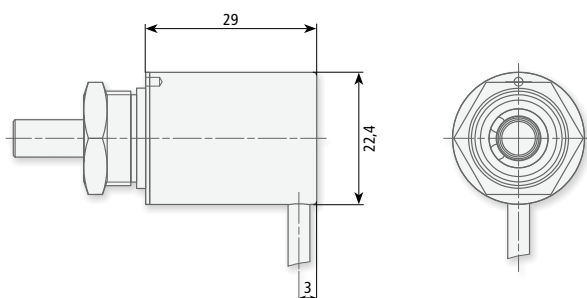

CMV22 SSI, ASI

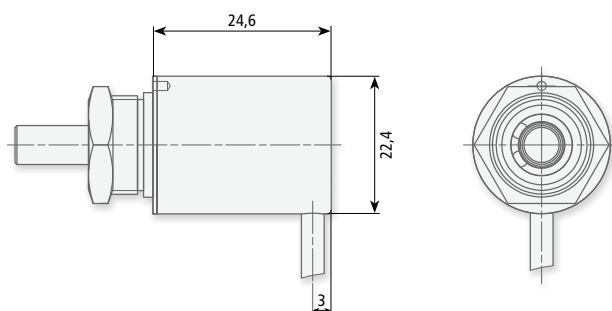

Shaft Types

Shaft 6mm

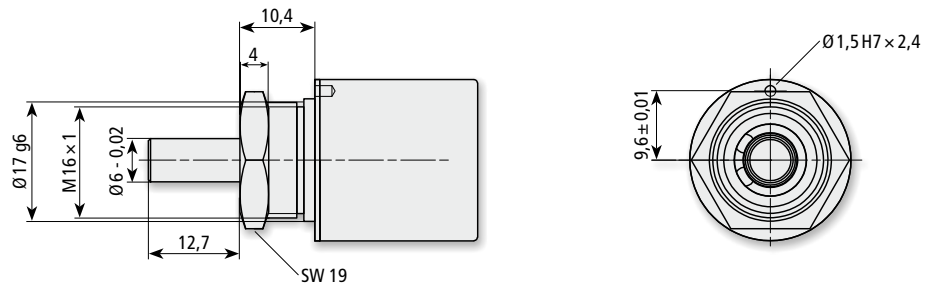

Shaft 6,35mm
1/4"

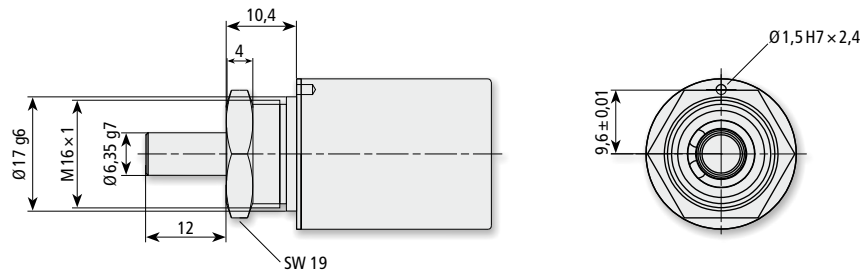

Shaft 3mm
With flat

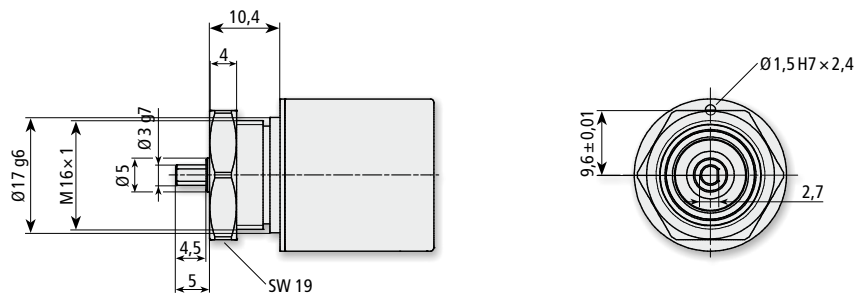



TR-Electronic GmbH

Eglishalde 6
D - 78647 Trossingen

Tel. +49 7425 228-0
Fax +49 7425 228-33

info@tr-electronic.de
www.tr-electronic.de

